

Security Gate MBG GOOD DESIGN AWARD 2017

COMPACT and PORTABLE

MBG is suitable for short-term events such as exhibitions and international conferences. This product controls the authorized passages and ensures the easy installation and removal, with the compact and lightweight body and the removable casters.



1. WIDE POSSIBILITY



Suitable for...

- Event Sites
- Outdoor Entrance
- Temporary Use

Compact design makes it possible to install at narrow area

2. FEATURES

Easy installation and relocation

Light-weight and compact body enable us to install and relocate the product easily. The optional conveyor base has wheels, which helps to carry the body everywhere. Therefore, this portable gate is the best suited for temporary use, event sites and so on.

High waterproof and dustproof performance

This product has waterproof and dustproof performance equivalent to Ingress Protection Code IP55 can be installed outside.

Safety design

The soft urethane-made flap panels are provided for the safe passages. These flap panels prevent users from hurting while closing.

Authentication part

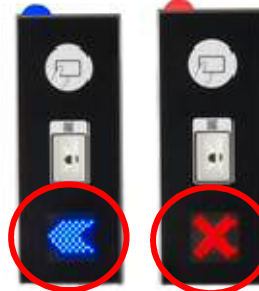

- Passage allowed(Left)
- Passage not allowed/ error(Right)



Security Gate MBG

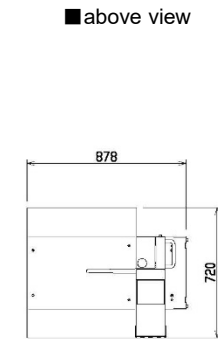
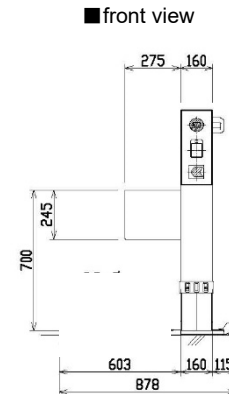
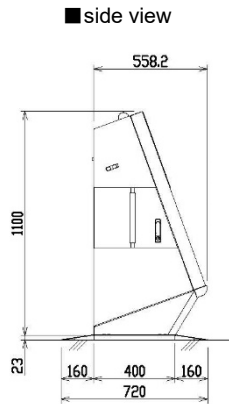

Access control system	Not included
Direction	One direction
Passage capacity	25 people/ min.
Necessary time to open/ close	Changeable within the range 0.35 - 0.85 sec.
Dimensions for gate body	W160 x H1,100 x D560 mm
Height of flap panel	700 mm over the floor
Net weight	40kg (Optional parts are not included)
Aisle width	Approximately 600 mm
Main exterior materials	Body : Stainless steel, Galvanizing steel plate, Polycarbonate, Polypropylene resin Flap panel : Urethane Structural members : Galvanizing steel plate, Stainless steel, Structural steel
Finish	Stainless : Hairline finish
Power supply	AC90V-110V 50/ 60Hz with grounding * A transformer is needed for overseas market.
Consuming power	Not in use : 8.7W/11.8VA In use : 64.4W/84.4VA (Optional parts are not included) Not in use : 153W/153VA In use : 207W/219VA (Optional parts are all included)
Power failure	Flap panels can be opened easily with your hands in case of power failure.
Operation environment	0 - 40°C without cooling/ heater fan unit(option) -10 - 45°C with cooling/heater fan unit(option) Wind pressure resistance : up to 10m/s
Installation	Indoor/ Outdoor (It should be a place with a roof to avoid raining or snowing directly and salt damage.)